

# The Royal Infirmary of Edinburgh

## Main Entrances and Car Parking

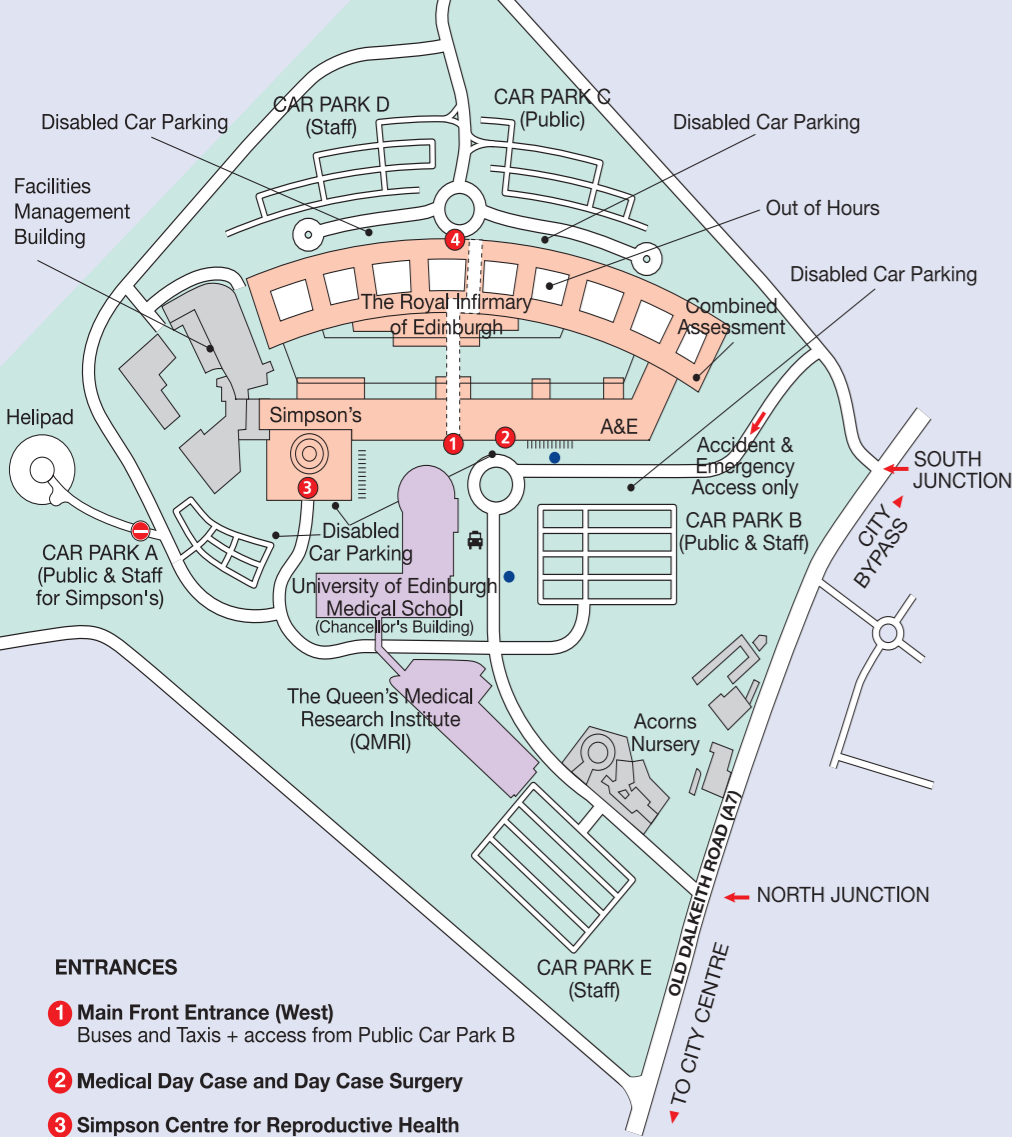

### ENTRANCES

- 1 Main Front Entrance (West)**  
Buses and Taxis + access from Public Car Park B
- 2 Medical Day Case and Day Case Surgery**
- 3 Simpson Centre for Reproductive Health**  
Outpatient + Access from Public Car Park A
- 4 Main Rear Entrance (East)**  
Access from Public Car Park C

- Bus Stops
- 🚗 Taxis
- 🚲 Cycle Racks

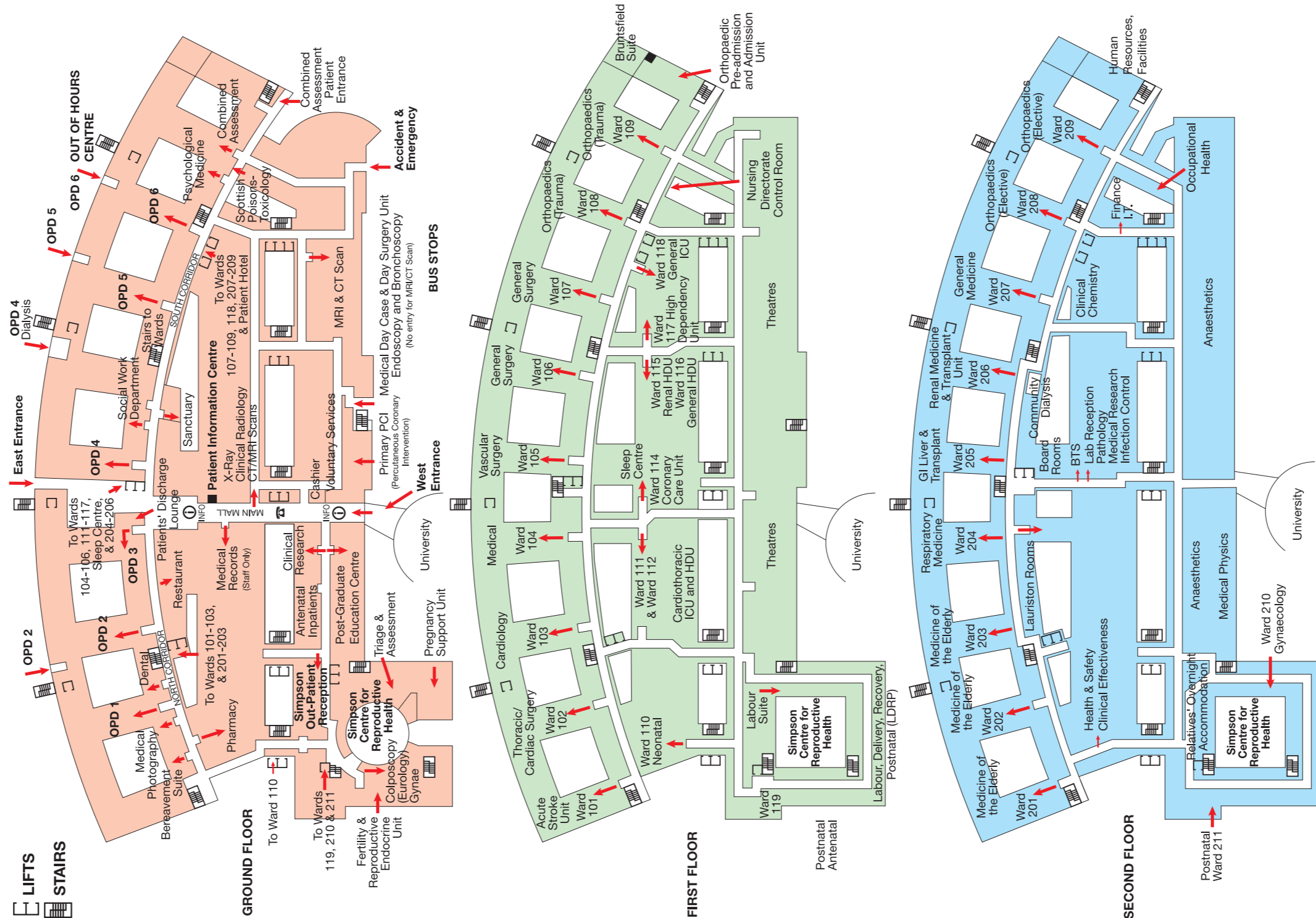

## Inpatient Wards (in alphabetical order)

SPECIALTY	WARD
Acute Stroke Unit	101
Cardiothoracic Intensive Care Unit	111
Cardiothoracic High Dependency Unit	112
Cardiology	103
Coronary Care Unit	114
General Surgery	106
General Surgery	107
General Medicine	207
GI Liver and Transplants	205
Gynaecology (Simpson's)	210
High Dependency Unit (General)	116
High Dependency Unit	117
Intensive Care Unit (General)	118
Labour Suite (Simpson's)	Labour Suite
LDRP (Labour, Delivery, Recovery, Postnatal)	Enter by 119
Medicine of the Elderly	201
Medicine of the Elderly	202
Medicine of the Elderly	203
Medical Ward	104
Neonatal	110
Orthopaedics (Elective)	209
Orthopaedics (Trauma)	108
Orthopaedics (Trauma)	109
Orthopaedics (Elective)	208
Postnatal (Simpson's)	211
Postnatal/Antenatal (Simpson's)	119
Renal High Dependency Unit	115
Renal Medicine and Transplant Unit	206
Respiratory Medicine	204
Sleep Medicine	114
Thoracic/Cardiac Surgery	102
Vascular and General Surgery	105

## Outpatient Departments (OPD)

- OPD 1** • Cardiothoracic Surgery • General Surgery 1 • Haemophilia Centre • Lipid Clinic • Sleep Centre Clinic • Stem Cell Separator Unit • Transplant • Tuberculosis Clinic
- OPD 2** • Crohn's • Diabetes & Medical OPD • Diabetic/Foot Clinic • Deep Vein Thrombosis (DVT) • Endocrinology • Endocrine Thyroid • General Medicine • Haematology • Hypertension • Medicine of the Elderly • Neurology • Neurovascular • Weight Management • 24 hr Ambulatory Blood Pressure Monitoring (ABPM)
- OPD 3** • Asthma • BCG • Cardiology • Cardiothoracic Surgery • Cardiovascular • Electrocardiogram (ECG) • Pacemaker • Respiratory Function • Respiratory Medicine (RVCC) • Tuberculosis (TB) Clinic • Thoracic & Respiratory • Vascular Clinic • Vascular Lab
- OPD 4** • Dialysis/Metabolic Renal Unit (MRU) • Gallbladder • Gastroenterology • General Surgery • Gastro-Intestinal (GI) Liver/Renal • Hepatobiliary • Hernia • Pain Clinic • Post Transplant • Renal Medicine • Vascular
- OPD 5** • Occupational Health • Physiotherapy Outpatients • Rehabilitation • Dietetics • Speech and Language Therapy Outpatients
- OPD 6** • Foot Clinic • Fracture Clinic • Orthopaedic Outpatients • Orthopaedic X-Ray • Orthotics • Peacock Clinic • Pre-Admission Clinics (Orthopaedic) • Out of Hours Centre

